

1.5" MECH. LOCK 0.032" ALUM. 16" WIDE LOAD TABLE OVER 15/32" PLYWOOD

COASTAL
METAL
ROOFING

Buildings having a Roof Mean Height \leq 20'-0"; Roof Slope: 2"/12" -6"/12" Gable or Hip Roof
Wind Speeds 120-150 mph, Exp C, Risk Category II, Enclosed Bldg. based on FLORIDA BUILDING CODE 2010

1.5" MECHANICAL LOCK, 0.032" ALUM., 16" WIDE, CLIP SPACING						
ZONE	FASTENER	SUBSTRATE	WIND SPEED ZONE			
			120 ON CENTER SPACING	130 ON CENTER SPACING	140 ON CENTER SPACING	150 ON CENTER SPACING
ZONE 1	(2) #10-12	15/32" PLYWOOD	12"	12"	12"	12"
ZONE 2	(2) #10-12	15/32" PLYWOOD	12"	12"	12"	12"
ZONE 3	(2) #10-12	15/32" PLYWOOD	6"	6"	6"	6"

- PANEL DESCRIPTION:** 1.5" MECHANICAL LOCK, MIN. 0.032" ALUM., 16" MAX WIDTH, 1-1/2" TALL RIB DOUBLE LOCK SEAM.
- PANEL FASTENER:** (2) #10-12 PANCAKE TYPE A PER CLIP.
- PANEL CLIP:** TWO PIECE SLIDER CLIP, TOP PIECE 26 GA. STAINLESS STEEL, BOTTOM PIECE 24 GA. STAINLESS STEEL.
- MAXIMUM ALLOWABLE PANEL UPLIFT PRESSURE:** 76.8 PSF AT 12" O.C., 89.3 PSF AT 6" O.C. PRESSURE BASED ON UL 580 TESTING UL 580/1897 BY FORCE ENGINEERING & TESTING, INC., REPORT #115-103T-05.
- PLYWOOD DECKING:** MIN. 15/32" THICK, APA RATED PLYWOOD. PLYWOOD MUST BE DESIGNED IN ACCORDANCE WITH FBC 2010.
- LOAD TABLE** BASED ON WIND PRESSURES CALCULATED PER ASCE 7-10 ($K_d=0.85$) MULTIPLIED BY 0.6 PER FBC 2010, SECTION 1609.1.5.
- LOAD TABLE DOES NOT INCLUDE OVERHANG ZONES.**

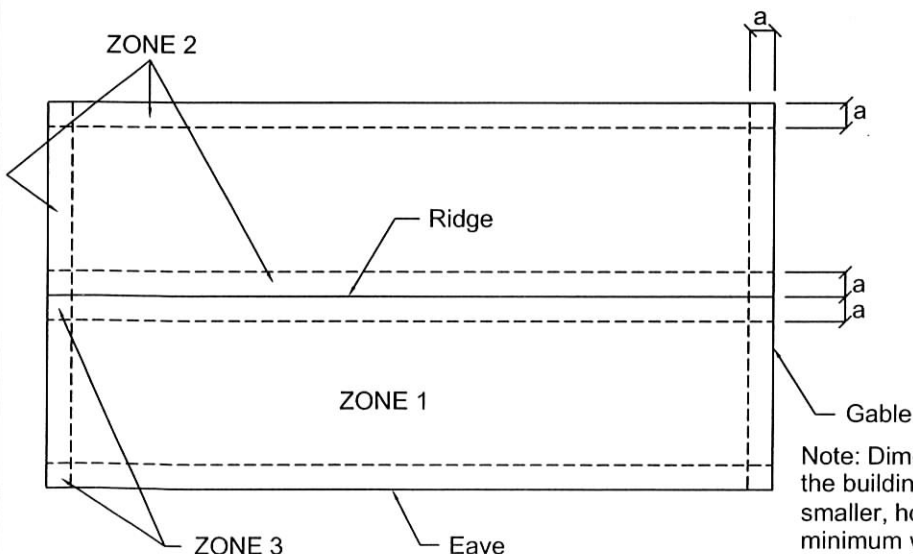
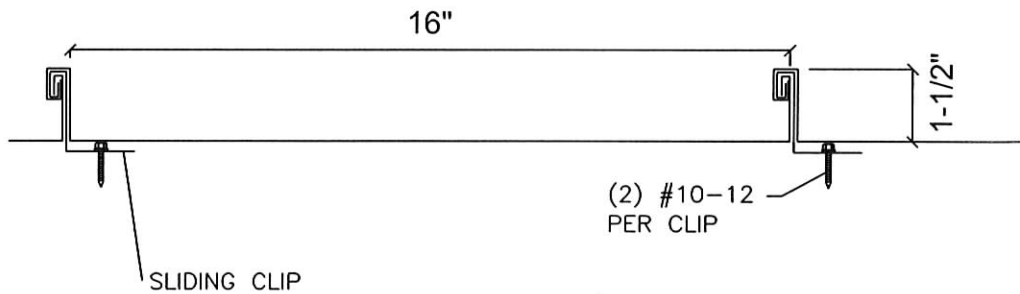

State of Florida
C.O.A.
23778



Note: Dimension (a) is defined as 10% of the minimum width of the building or 40% of the mean height of the roof, whichever is smaller, however, (a) cannot be less than either 4% of the minimum width of the building or 3 feet.